

Stage area approx
4.5-5.5m W x 4.5m D
Stage headroom approx 2.4m
to lanterns, 2.9m to grid

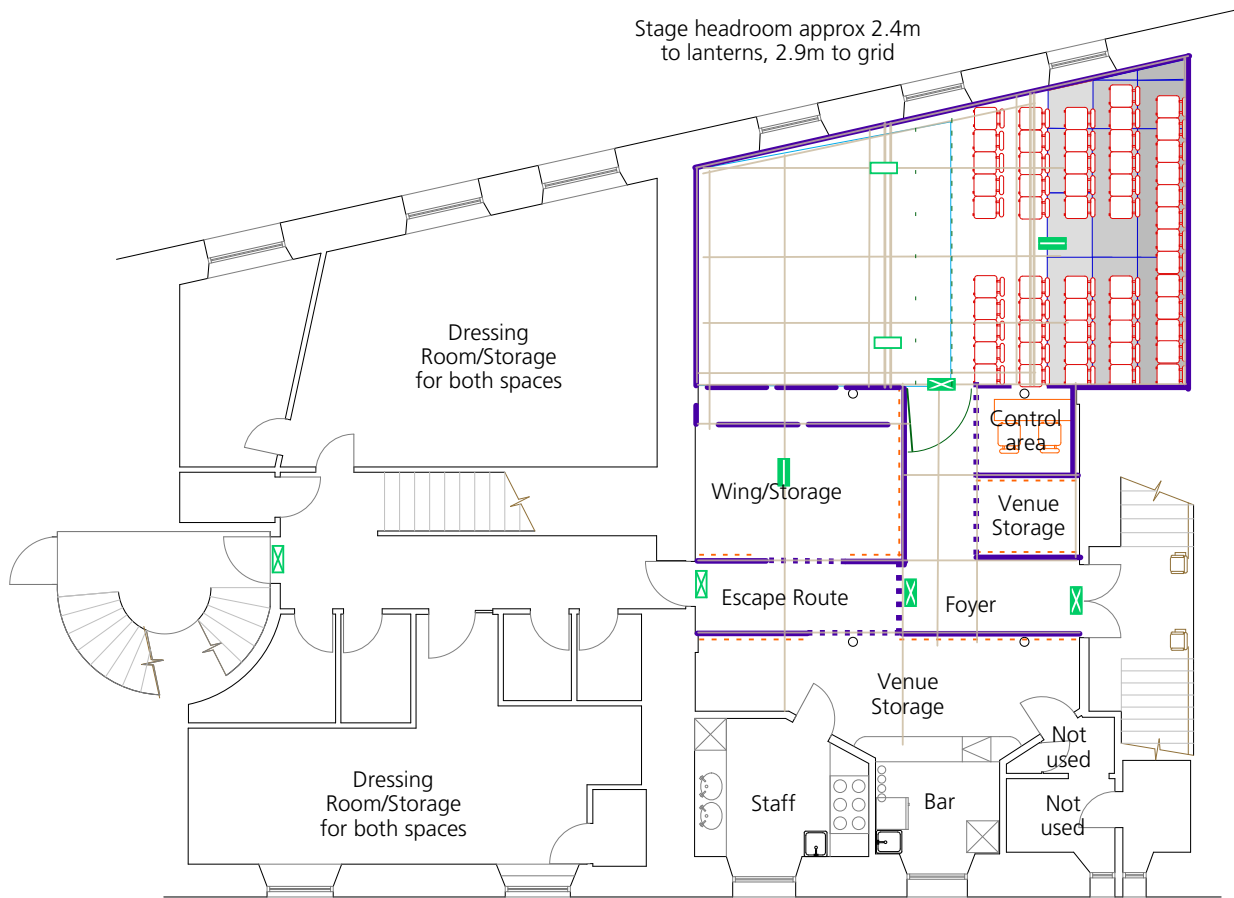

key

- escape route sign (maintained)
- bulkhead (maintained)
- bulkhead (non-maintained)
- fittings/furniture
- truss
- scaffolding at grid height
- scaffolding upright
- scaffolding waste and knee rails
- solid handrail
- black drape
- openable black drape on track
- FOH display board/partition
- internal poster wall/drape
- limit of playing area
- no scenic pieces downstage of this line
- seats (fixed)
- seats (can be removed by arrangement)

rostra/steps/steeldeck heights

- + 180mm
- + 360mm
- + 540mm
- + 720mm
- + 900mm
- + 1080mm
- + 1260mm
- + 1440mm

C venues ltd accepts no liability for any inaccuracies
This plan is provisional and subject to change

For further information please contact C venues on
+44 (0)131 581 5820 or email production@cvenues.com

Copyright © C venues ltd – plan updated 23 July 2018

Scale
0 1m

C aquila

Roman Eagle Lodge

Level +1

Studio